

SERIE 5300



Pasaje 4,0 mm

Características

- Cuerpo de bronce niquelado
- Buje móvil de acero zincado
- Resortes y bolillas de acero inoxidable
- Juntas de Nitrilo (-30°C a 120°C)
- Presión de servicio 20 bars
- Acoplamiento automático
- Pasaje 4,00 mm.

Opciones

- Juntas de:
- Vitón
 - Etileno Propileno
 - Neoprene
 - Silicona

Curva de Presión / Caudal

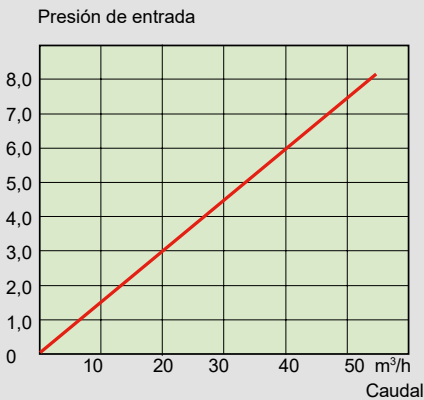

Caudal de aire a 6 Bars: 40 m³/h
(664 l/mn)

Descripción

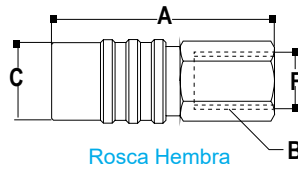

F	Código	A	B	C	F1
1/8 BSP	5301	52.00	5/8"	20.00	
1/4 BSP	5302	54.00	5/8"	20.00	

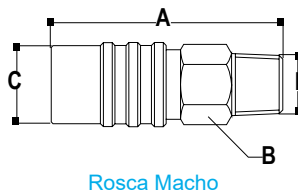

1/8 BSP	5306	50.00	5/8"	20.00	
1/4 BSP	5307	52.00	5/8"	20.00	

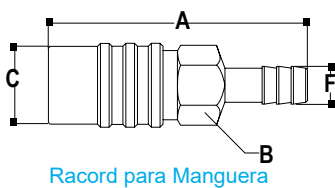

1/4"	5311	62.00	5/8"	20.00	
5/16"	5312	62.00	5/8"	20.00	

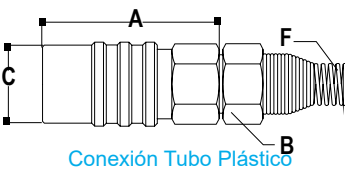

1/4"	5318	40.00	5/8"	20.00	
5/16"	5319	40.00	5/8"	20.00	

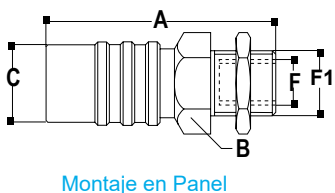

1/8 BSP	5322	52.00	7/8"	20.00	M18
---------	-------------	-------	------	-------	-----

DATOS TÉCNICOS

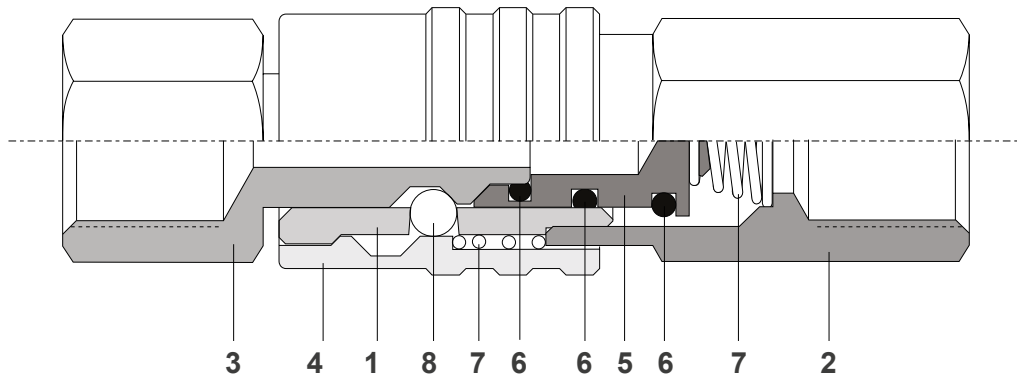

- | | |
|--|---|
| 1- Cuerpo Principal (Latón niquelado) | 5- Válvula (Acero tratado termicamente y zincado) |
| 2- Cuerpo Inferior (Latón niquelado) | 6- Sellos (Nitrilo) |
| 3- Conector (Acero tratado termicamente y zincado) | 7- Resortes (Acero inoxidable) |
| 4- Buje Móvil (Acero zincado) | 8- Bolillas (Acero inoxidable) |

CONECTORES SERIE 5300

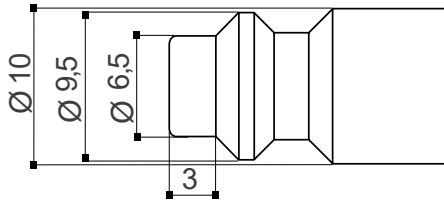

Características

- Acero zincado anticorrosivo
- Tratados termicamente
- Alta resistencia al uso

Descripción	F	Código	A	B	C	Fl
-------------	---	--------	---	---	---	----

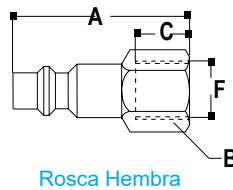

Rosca Hembra

1/8 BSP	5326	33.00	9/16"	10.00		
1/4 BSP	5327	35.00	5/8"	12.00		

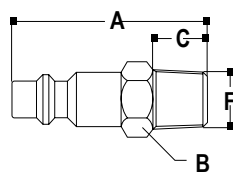

Rosca Macho

1/8 BSPT	5330	37.00	1/2"	10.00		
1/4 BSPT	5331	39.00	9/16"	12.00		

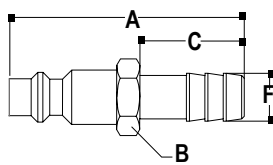

Racord para Manguera

1/4"	5335	48.00	7/16"	22.00		
5/16"	5336	48.00	7/16"	22.00		
3/8"	5337	48.00	7/16"	22.00		

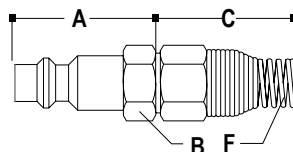

Conexión Tubo Plástico

1/4"	5342	25.00	9/16"	92.00		
5/16"	5343	25.00	9/16"	98.00		